



V122L Brushless DC Motor Drone

Our Product Introduction

for more products please visit us on uav-vtoldrone.com

Basic Information

- Place of Origin: Guangdong, China
- Brand Name: GS
- Model Number: V122L 36KV
- Price: Negotiable
- Delivery Time: 6-8
- Payment Terms: T/T
- Supply Ability: 100



Product Specification

- Motor Model: V122L IPE W2.0
- Motor Size: D:144.6x53 Mm
- Propeller Mounting Holes: D:50 M6x6
- Shaft Diameter: IN: 20 Mm
- Bearing: 6904ZZ*2
- Cable Length: 150 Mm (extended Enameled Wires)
- Rotor Balance: ≤ 10 Mg
- Motor Balance: ≤ 20 Mg
- Motor Mounting Holes: D:50 M6x4
- Disruptive Test: 500 V
- Highlight: Drone Brushless DC Motor, V122L Brushless DC Motor



More Images



Product Description

V122L Brushless DC Motor Drone

Product Specifications

Attribute	Value
Motor Model	V122L IPE W2.0
Motor Size	D:144.6x53 mm
Propeller Mounting Holes	D:50 M6x6
Shaft Diameter	IN: 20 mm
Bearing	6904ZZ*2
Cable Length	150 mm (extended Enameled wires)
Rotor Balance	≤10 mg
Motor Balance	≤20 mg
Motor Mounting Holes	D:50 M6x4
Disruptive test	500 V

Product Description

Designed to carry payloads of 18-21kg (39.6-46.29lbs) per rotor with 47.5" carbon propeller. The V122L Brushless DC Motor delivers maximum thrust up to 50kg (110.23lbs) per rotor while weighing only 1620g. Featuring large pitch VOTL CF propellers, this motor provides exceptional load capacity, high efficiency, and reliable performance for professional UAV endurance flights.

RPMNV

36 KV

Nominal Voltage

24S lipo battery

No Load Current

1.06A/30V

Internal resistance

81mΩ

Motor Weight

1620 g

Product Boxed Weight

2600g (260x210x120 mm)

Maximum Current

133 A

Maximum Power

12830W

Maximum thrust

50 kg

Maximum Torque

34 Nm

Recommended ESC

Recommended Propellers

47.5x17.4

V122L

ENERGY EFFICIENT 36KV
INDUSTRY PROFESSIONAL EDITION

18~21 kgf

RECOMMENDED
HOVER THRUST

50 kgf

MAXIMUM
THRUSTMAXIMUM THRUST MAY DEPEND ON
BATTERY LEVEL, PROPPELLER TYPE,
AIR PRESSURE AND OTHER CONDITIONSOPTIMIZED
WEIGHT 1620g

EFFICIENCY >85%



MAD V122L IPE 36KV FLUXER PRO 47.5x17.4 GLOSSY AMPX 200A (12-24S)

24S

MAX
89°C

Analytical Graph of Motor Operation

I – Current, P – Input Power, η – Electrical Efficiency, T – Thrust, N – Rotational Speed

The data above was measured with an input voltage of 96 V, at a temperature of 25°C and sea level. The rotational speed was adjusted by the throttle.

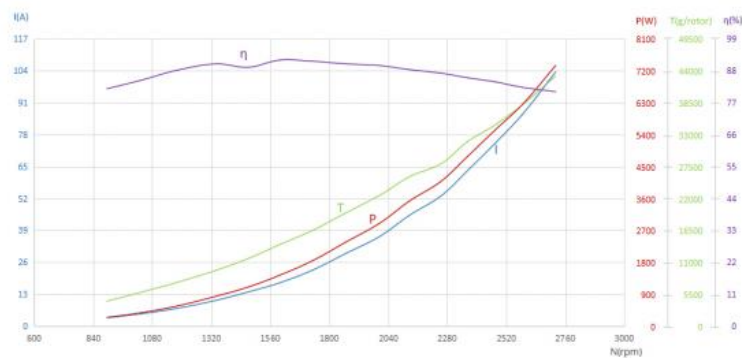

Motor Data

Motor Model	MAD V122L IPE V2.0	Number of pole pairs	19
Stator	TAIWAN / Anticorrosive	Varnished wire Degree	220°C
Motor Size	D:144.6 × 53 mm	Magnet Degree	180°C
Degree of Protection	IP35	Cable Length	150 mm (extended Enameled wires)
Centrifugal Heat Dissipation	YES	Rotor Balance	≤10 mg
Propeller Mounting Holes	D:50 M6×6	Motor Balance	≤20 mg
Shaft Diameter	IN: 20 mm	Motor Mounting Holes	D:50 M6×4
Bearing	EZO 6904ZZ *2	Disruptive test	500 V
Additional Accessories	Propeller Plate *1, Locate Pin *1, 8.0mm Bullet Connector*3, Heat Shrinkable Tube*3, M6*25mm *4 Motor Screws, M6*40mm *6 Propeller Screws, Sticker*2		

Specifications

RPM/V	36 KV	Nominal Voltage	24S lipo battery
No Load Current	1.06A/30V	Internal resistance	81mΩ
Motor Weight	1620 g	Product Boxed Weight	2600g (260 x 210 x 120 mm)
Maximum Current	133 A	Maximum Power	12830W
Maximum thrust	50 kg	Maximum Torque	34 Nm
Recommended ESC	MAD AMPX 200A (12-24S)	Recommended Propellers	47.5x17.4
UAV take-off weight	245-47.5' 76kg--Quadcopter 114kg--Hexacopter 152kg--Octocopter	Single rotor take-off weight	18kg ~ 21kg

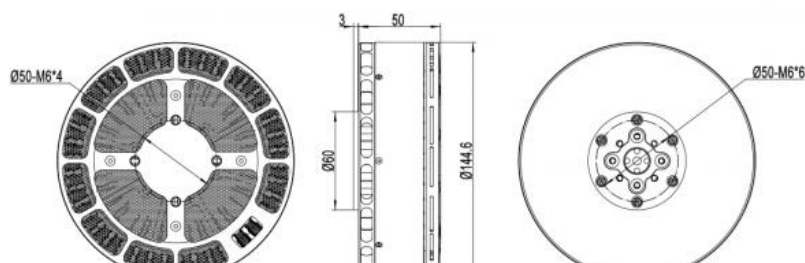

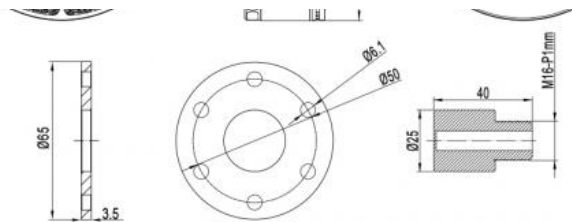

MAD V122L IPE 36KV FLUXER PRO 47.5x17.4 GLOSSY AMPX 200A (12-24S)									24S	MAX 89°C
Throttle [%]	Voltage [V]	Current [A]	Input Power [W]	Output Power [W]	Torque [N·m]	RPM	Thrust [gf]	Efficiency [%]	Efficiency [gf/W]	
30	88.81	3.33	295.7	242.0	2.579	896	4288	81.8	14.5	
35	88.77	5.01	444.7	376.9	3.471	1037	5854	84.8	13.2	
40	88.78	7.2	639.2	563.5	4.556	1181	7521	88.2	11.8	
45	88.73	10.5	931.7	841.9	5.995	1341	9623	90.4	10.3	
50	88.68	13.88	1230.9	1098.5	7.136	1470	11633	89.2	9.5	
55	88.66	17.66	1565.7	1435.7	8.569	1600	14063	91.7	9.0	
60	88.62	22.77	2017.9	1841.9	10.155	1732	16480	91.3	8.2	
65	88.56	29.54	2616.1	2364.7	12.095	1867	19494	90.4	7.5	
70	88.49	36.55	3234.3	2903.8	13.823	2006	22554	89.8	7.0	
75	88.38	45.17	3992.1	3529.3	15.845	2127	25747	88.4	6.4	
80	88.32	52.88	4670.4	4072.6	17.263	2253	27929	87.2	6.0	
85	88.23	63.36	5590.3	4785.3	19.340	2363	31808	85.6	5.7	
90	88.19	74.4	6561.3	5524.6	21.326	2474	34649	84.2	5.3	
95	88.06	86.25	7595.2	6250.8	23.084	2586	38143	82.3	5.0	
100	87.84	103.57	9097.6	7350.9	25.800	2721	43101	80.8	4.7	

MAD V122L IPE 36KV 48 inch plastic Propeller AMPX 200A (12-24S)									24S	MAX 90°C
Throttle [%]	Voltage [V]	Current [A]	Input Power [W]	Output Power [W]	Torque [N·m]	RPM	Thrust [gf]	Efficiency [%]	Efficiency [gf/W]	
30	87.95	3.61	317.5	255.5	2.735	892	4682	80.5	14.7	
35	87.95	5.68	499.6	420.3	3.874	1036	6407	84.1	12.8	
40	87.91	7.97	700.6	601.6	4.927	1166	8123	85.9	11.6	
45	87.88	11.55	1015.0	875.8	6.365	1314	10301	86.3	10.1	
50	87.85	15.47	1359.0	1195.0	7.859	1452	12933	87.9	9.5	
55	87.79	20.1	1764.6	1539.0	9.349	1572	15125	87.2	8.6	
60	87.73	25.26	2216.1	1953.3	10.985	1698	17740	88.1	8.0	
65	87.67	32.16	2819.5	2449.9	12.770	1832	20304	86.9	7.2	
70	87.61	40.17	3519.3	3020.1	14.699	1962	23233	85.8	6.6	
75	87.51	48.08	4207.5	3555.6	16.269	2087	26020	84.5	6.2	
80	87.39	58.96	5152.5	4342.7	18.884	2196	29901	84.3	5.8	
85	87.28	69.36	6053.7	5044.8	20.891	2306	32888	83.3	5.4	
90	87.14	81.55	7106.3	5680.4	22.517	2409	36269	79.9	5.1	
95	87.06	93.57	8146.2	6362.2	24.207	2510	38807	78.1	4.8	
100	86.8	113.74	9872.6	7582.2	27.574	2626	43463	76.8	4.4	

MAD V122L IPE 36KV 48 inch plastic Propeller AMPX 200A (12-24S)									24S	MAX 110°C
Throttle [%]	Voltage [V]	Current [A]	Input Power [W]	Output Power [W]	Torque [N·m]	RPM	Thrust [gf]	Efficiency [%]	Efficiency [gf/W]	
30	98.06	4.02	394.2	337.7	3.267	987	5703	85.7	14.5	
35	98.01	6.35	622.4	537.9	4.518	1137	7524	86.4	12.1	
40	98	9.51	932.0	813.9	5.988	1298	9966	87.3	10.7	
45	97.95	13.43	1315.5	1153.1	7.568	1455	12195	87.7	9.3	
50	97.9	18.03	1765.1	1557.5	9.348	1591	15086	88.2	8.5	
55	97.84	23.67	2315.9	2049.8	11.341	1726	18127	88.5	7.8	
60	97.76	30.43	2974.8	2617.3	13.380	1868	21126	88	7.1	
65	97.67	39.3	3838.4	3318.4	15.773	2009	24954	86.5	6.5	
70	97.61	48.16	4700.9	4003.9	17.825	2145	28612	85.2	6.1	
75	97.49	59.16	5767.5	4789.7	20.149	2270	31845	83	5.5	
80	97.39	70.14	6830.9	5642.3	22.602	2384	35425	82.6	5.2	
85	97.21	82.61	8030.5	6448.5	24.653	2498	38928	80.3	4.8	
90	97.05	96.73	9387.6	7331.7	26.951	2598	41903	78.1	4.5	
95	96.92	109.93	10654.4	8235.9	29.228	2691	44975	77.3	4.2	
100	96.69	132.69	12829.8	9840.5	34.025	2762	49597	76.7	3.9	

The above data are the theoretical values when the input voltage is 96V, for reference only. In the case of room temperature of 25°C and no additional cooling device, the current over 133A is non-working zone, 40-133A is short-term (about 10-30s), working zone, and below 40A is sustainable working zone. In actual use, please control the motor running time according to the working environment temperature and heat dissipation conditions.

Our Services

- 1 Year Warranty included for confident purchases
- 14-day return policy for replacements or refunds (contact required before return)
- 3-month defective item replacement with no extra charge (or refund after receiving defective item)
- Post-3-month defective item replacement available (customer responsible for return shipping)



Frequently Asked Questions

Q: Do you support OEM/ODM?

A: Yes. We can print your logo on the product.

Q: About samples.

A: Samples ready in 7 days (10-20 days for OEM/ODM). Sample fee and shipping charged.

Q: What is the delivery time?

A: Regular orders ship in 15 days, OEM/ODM in 25-45 days (quantity dependent). Delays communicated in advance.

Q: What is the minimum order quantity?

A: No MOQ for wholesale (1 piece accepted), including OEM/ODM.

Q: What are your payment terms?

A: L/C.TT100%.

Q: Can you reduce the shipping cost?

A: We always select the most economical and secure shipping option. Customers may arrange their own shipping if preferred.

Q: Return policy.

A: Replacement requests must be made within 7 days of receipt. Items must be in original condition with customer covering return shipping.



Guangzhou Gesai Intelligent Electronic Technology Co., Ltd.



Kellyyangjing2021@outlook.com



uav-vtoldrone.com

Fuli Yingtong Building, the Pearl River New Town, Tianhe District, Guangzhou, Guangdong, China